

GADNIC

MANUAL DE USUARIO

TABLET GRÁFICA

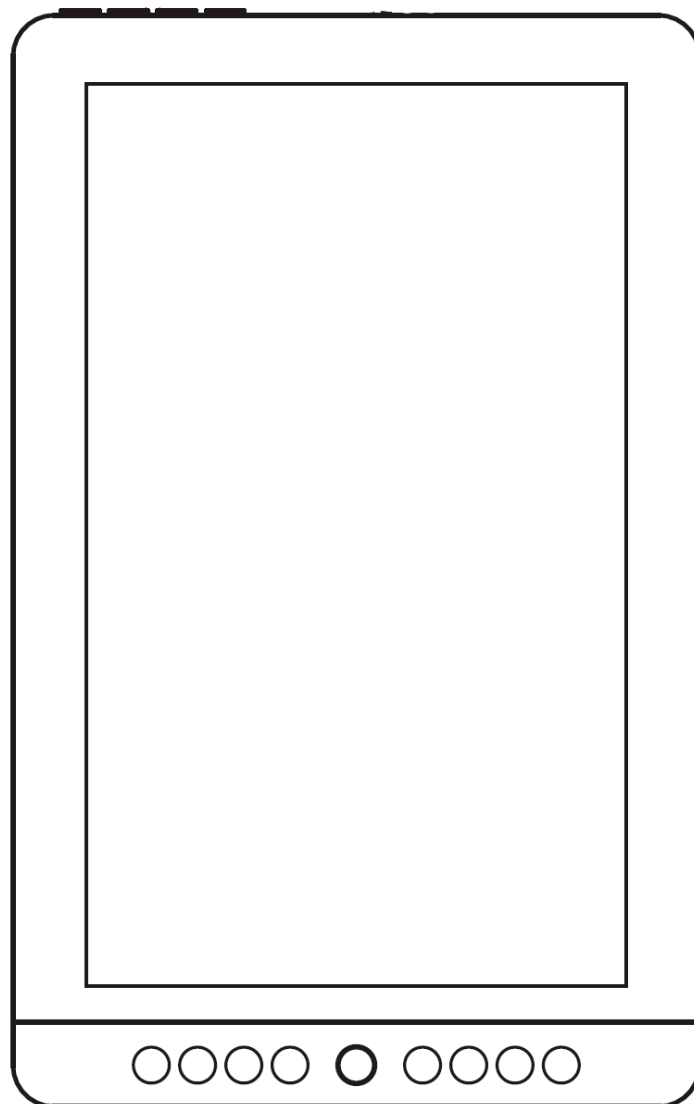

TABGRAF61

Índice

Español	5
Português	11
English	17

Manual de Usuario

Tableta digitalizadora

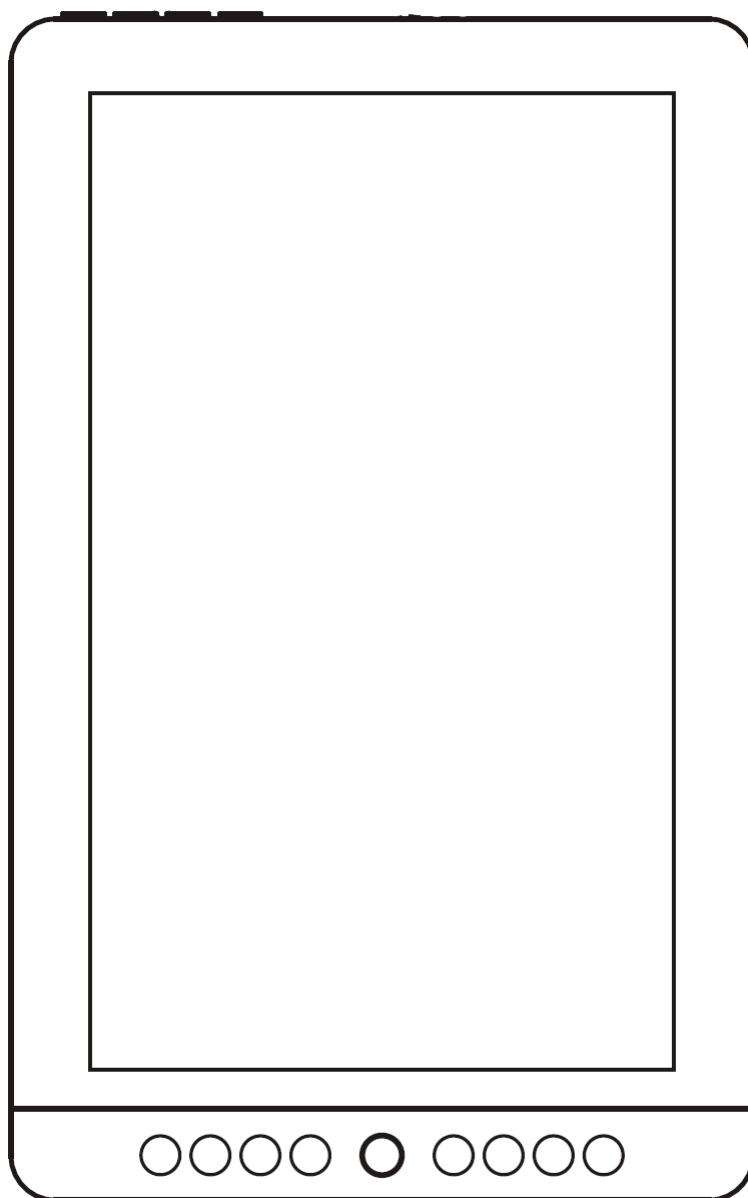

Descripcion general

1~8 8 Teclas personalizadas

9 Tecla de ajuste de Menú

10 miniHDMI

11 Tipo-C

12 Soporte plegable

13 Alfombrilla antideslizante

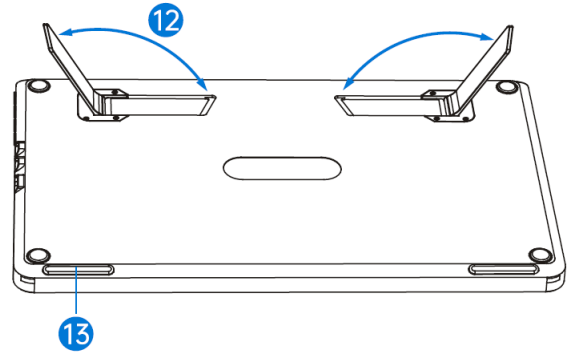
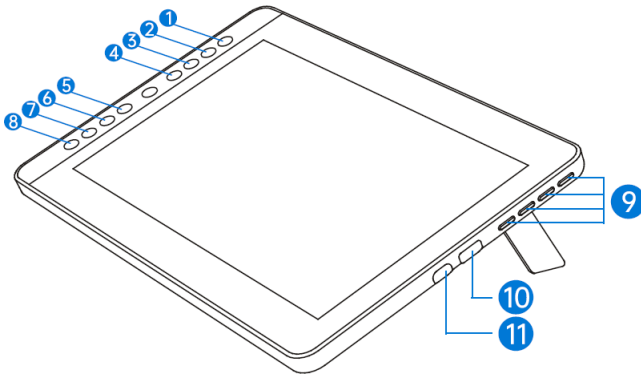

Conexion

Conecte su tableta con la computadora como se muestra:

1 mini HDMI

2 Tipo C

3 HDMI

4 USB

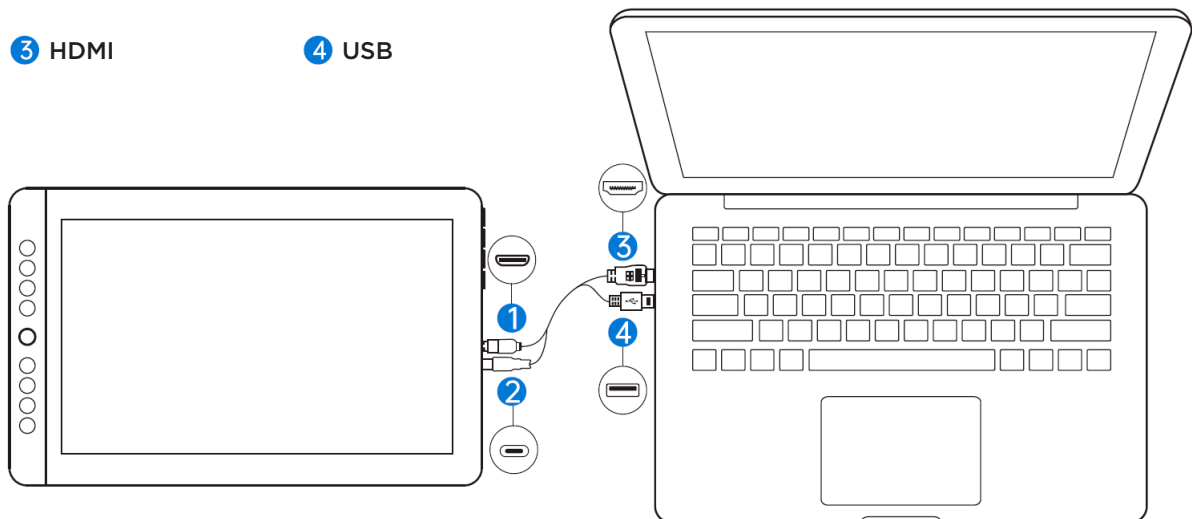

INSTALACIÓN DEL CONTROLADOR

1. Preparación antes de la instalación: Desinstale y elimine cualquier otro controlador de tableta gráfica/monitor instalado en su computadora, cierre todos los programas en ejecución, desactive temporalmente cualquier software antivirus y firewall, e instale el controlador como administrador.

2. Descargue el controlador de: <http://www.bostotablet.com/down.aspx>

3. Después de una instalación exitosa:

- **Windows:** Puede encontrar el icono “Digitizer” en el escritorio o en la esquina inferior derecha de la barra de tareas de su computadora.

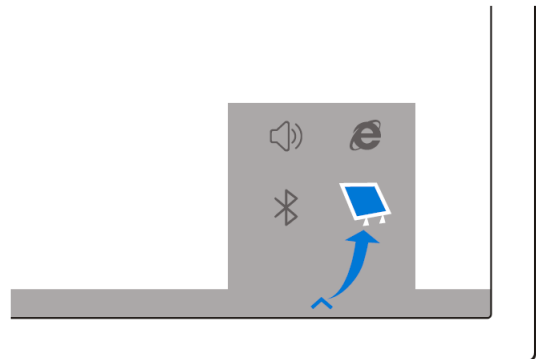
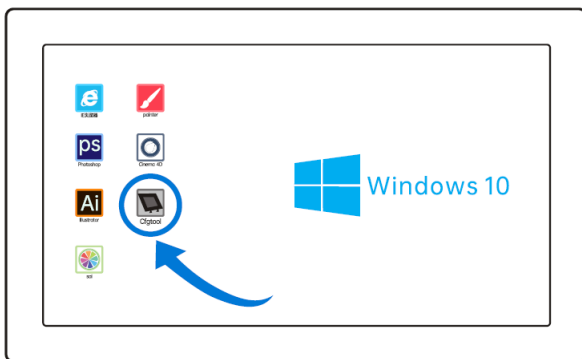

- **Mac:** Puede encontrar el icono “Tablet” en el “Launchpad”; después de hacer clic, verá el icono pequeño en la barra de navegación superior derecha (como se muestra en la imagen de abajo), haga clic para abrir el panel de configuración del controlador.

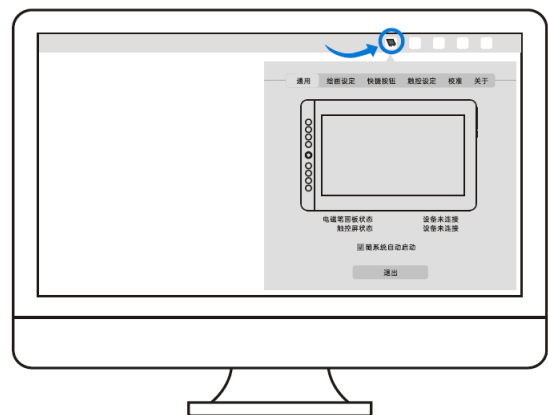
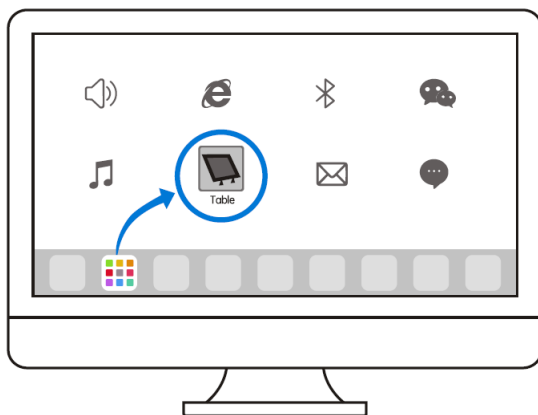

CALIBRACIÓN DE PANTALLA

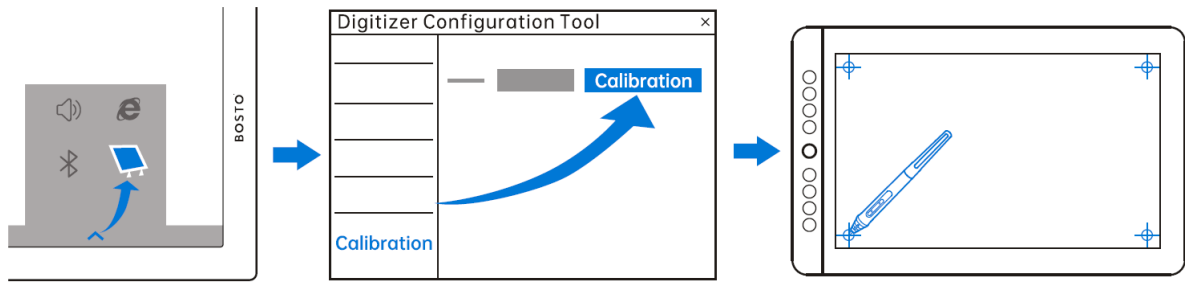

AJUSTES DE TOQUE TÁCTIL

(Solo para 12HDT / 12HDKT / 13HD)

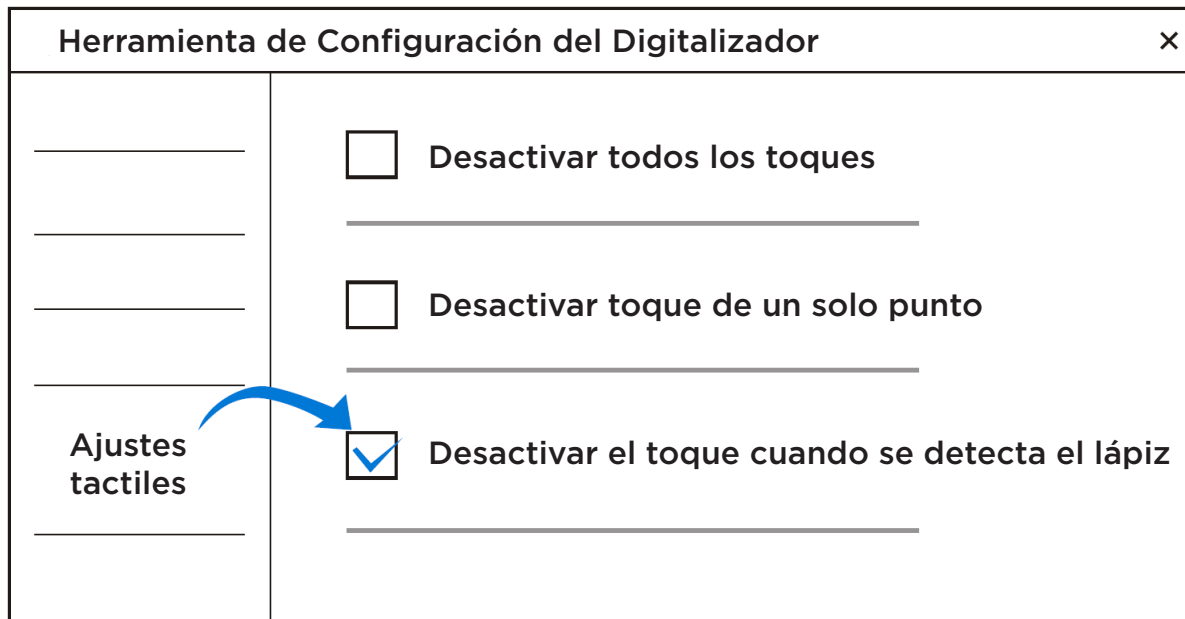

Nota: Seleccionar “Desactivar toque de un solo punto” puede reducir enormemente las operaciones falsas.

CONFIGURAR LAS TECLAS

(Solo para las series 12HDK / 13HD)

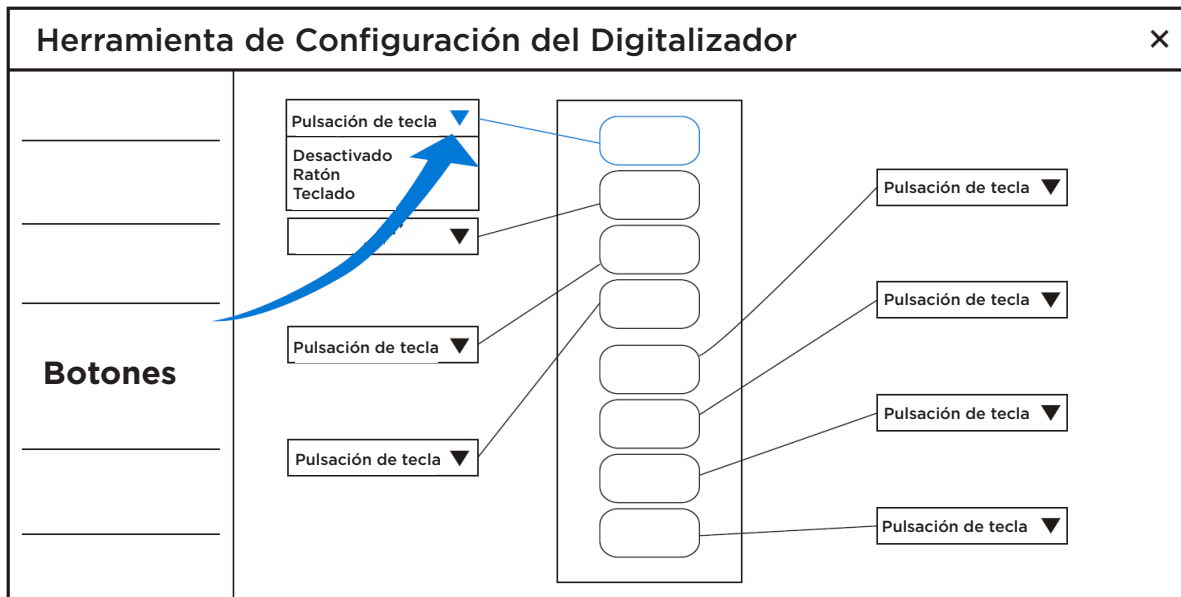

Nota: Las teclas de acceso rápido se pueden personalizar

Configurar como botones izquierdo y derecho del ratón.

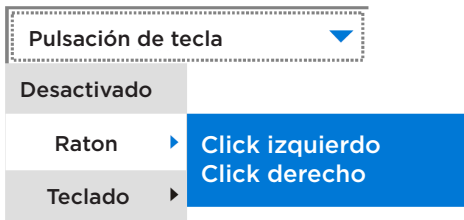

Configurar como tecla de teclado

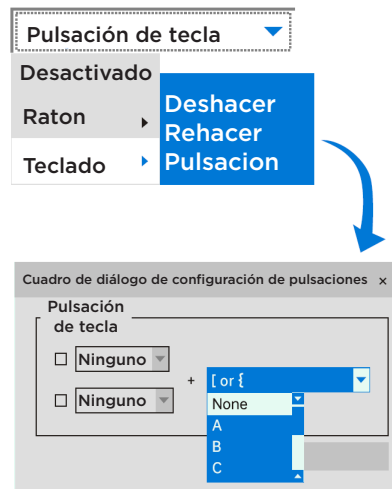

Establecer como combinación de teclas

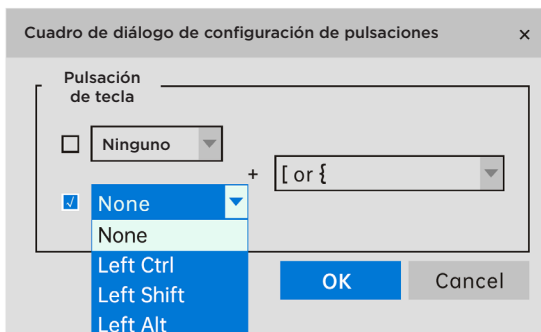

CONFIGURAR LA PLUMA SENSIBLE A LA PRESIÓN

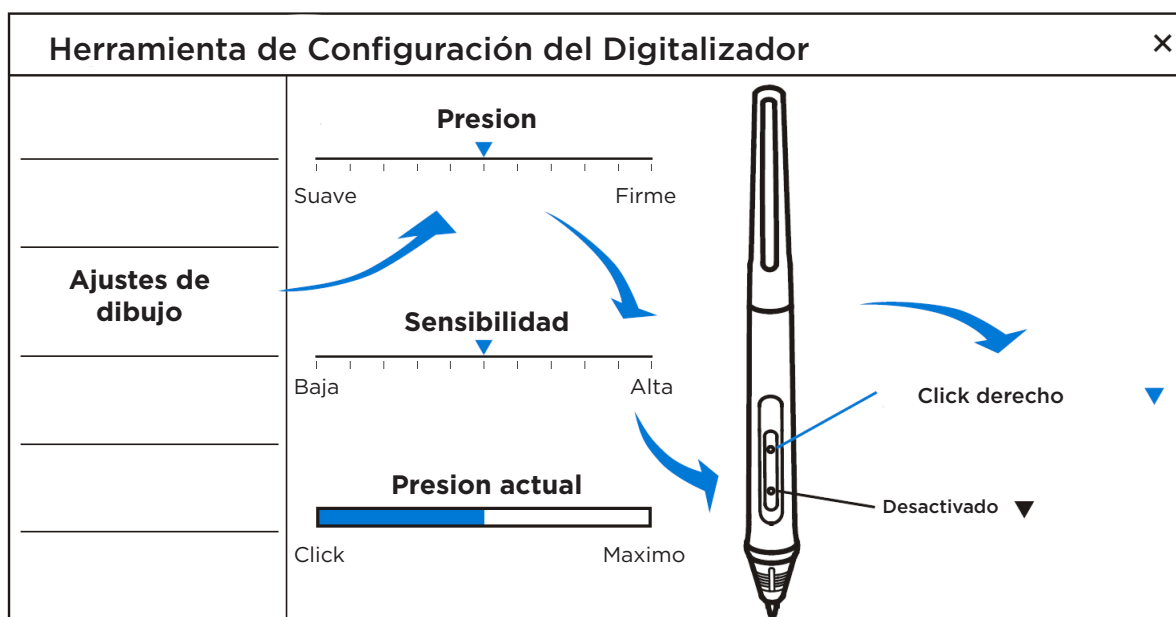

Ajuste de presión: Define la presión mínima necesaria para dibujar líneas. Mueve el deslizador hacia la derecha para que se requiera más presión al dibujar.

Ajuste de sensibilidad: Define los rangos de cambio en el grosor de las líneas correspondientes. Al mover el deslizador hacia la derecha, la línea será más gruesa aplicando la misma presión.

REEMPLAZAR LA PUNTA DE LA PLUMA



Manual de Usuário

Tableta digitalizadora

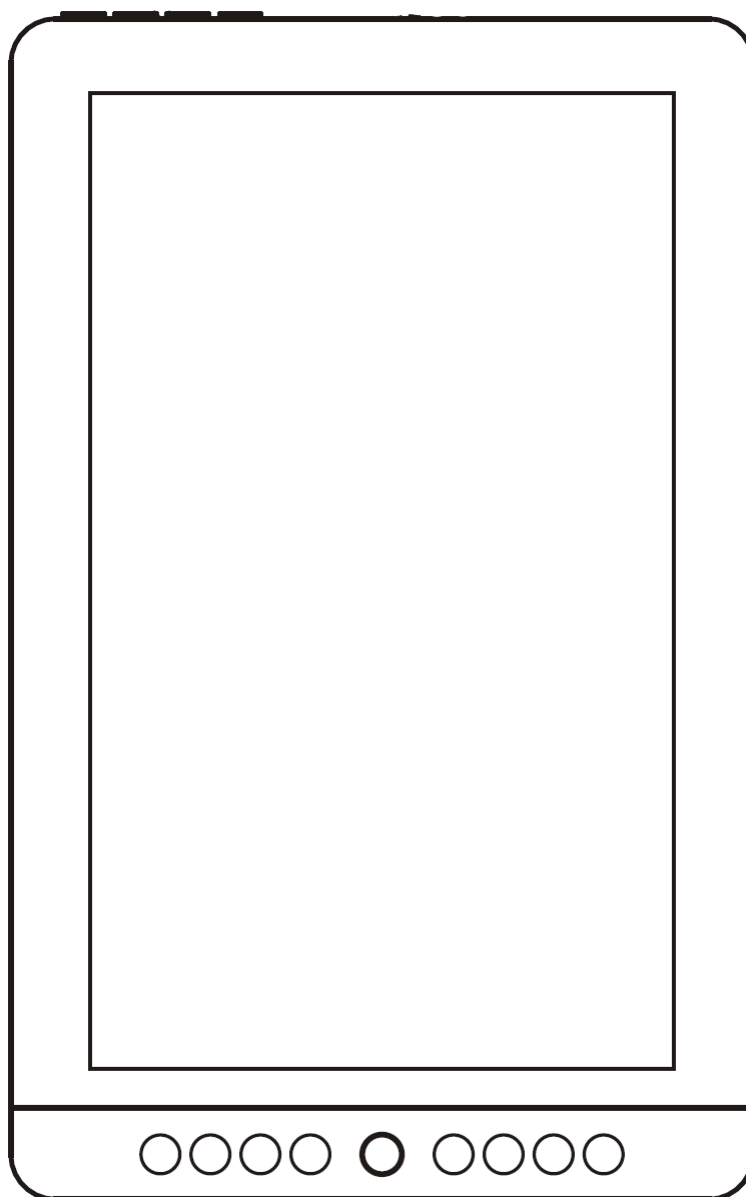

VISÃO GERAL

1~8 8 Teclas personalizadas

9 Tecla de ajuste de menu

10 miniHDMI

11 Tipo-C

12 Suporte dobrável

13 Tapete antiderrapante

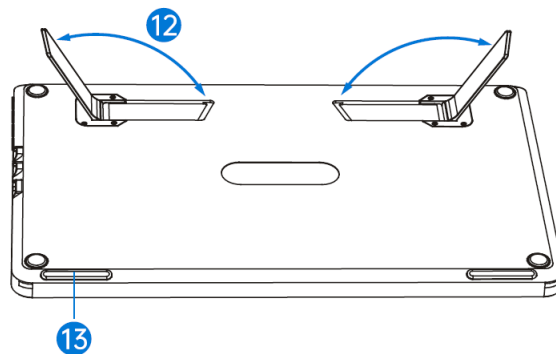
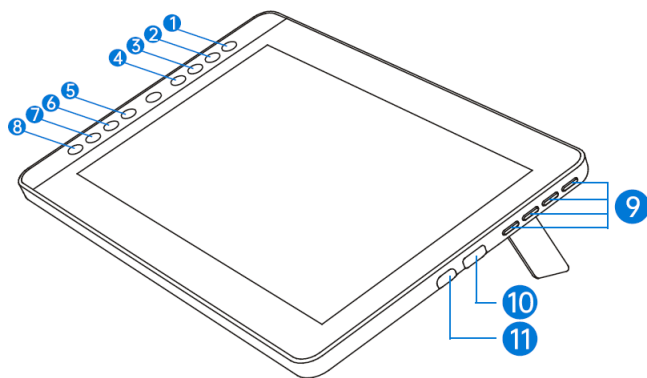

CONEXÃO

Conecte seu tablet ao computador conforme mostrado:

1 mini HDMI

2 Tipo C

3 HDMI

4 USB

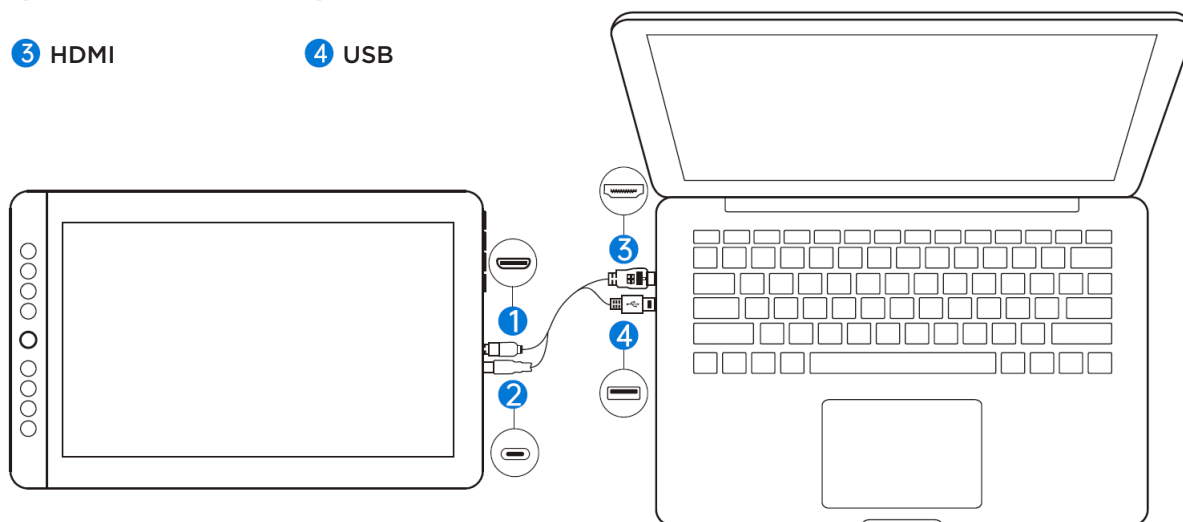

INSTALAÇÃO DO DRIVER

1. Preparação antes da instalação: Desinstale e remova outros drivers de mesas digitalizadoras/monitores instalados em seu computador, encerre todos os programas em execução, desative temporariamente qualquer software antivírus e firewall e instale o driver como administrador.

2. Baixe o driver em: <http://www.bostotablet.com/down.aspx>

3. Após uma instalação bem-sucedida:

- **Windows:** Você pode encontrar o ícone “Digitizer” (Digitalizador) na área de trabalho ou no canto inferior direito da barra de tarefas do seu computador.

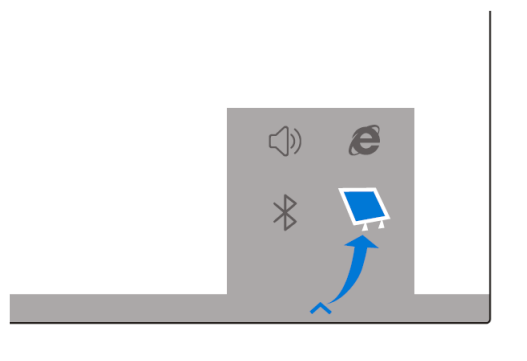
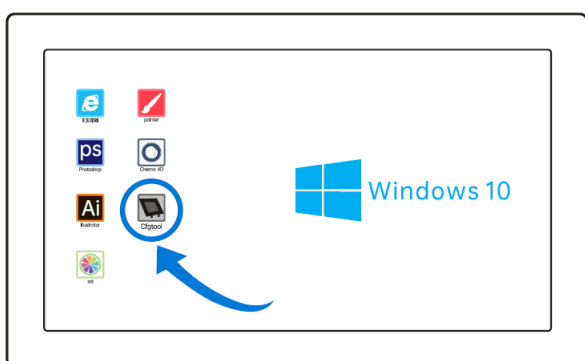

- **Mac:** Você pode encontrar o ícone “Tablet” no “Launchpad”. Após clicar nele, você verá o ícone pequeno na barra de navegação superior direita (conforme mostrado na imagem do manual); clique nele para abrir o painel de configurações do driver.

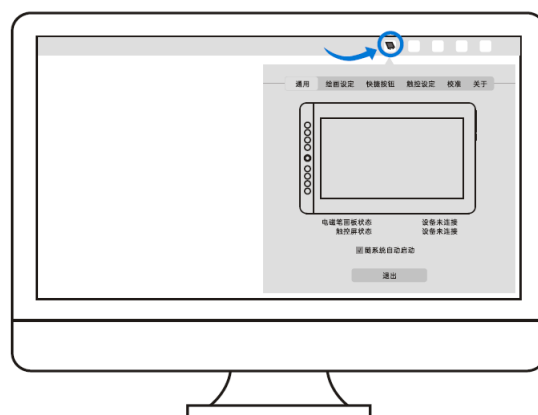
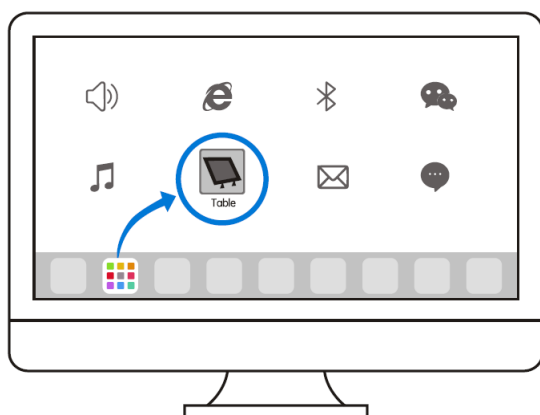

CALIBRAÇÃO DA TELA

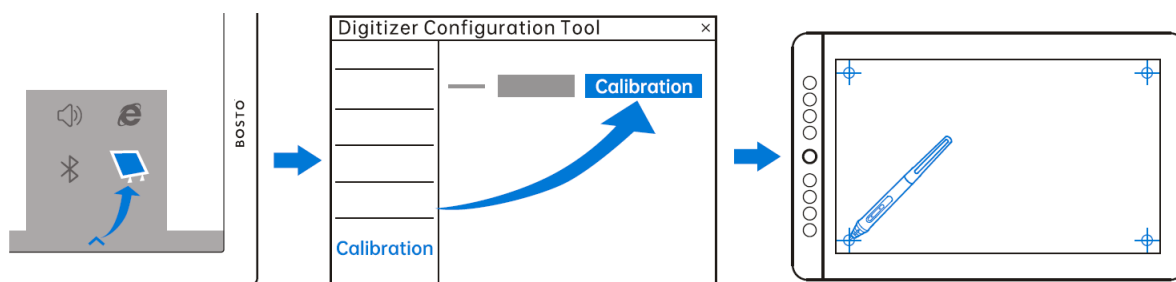

CONFIGURAÇÕES DE TOQUE

(Apenas para 12HDT/12HDKT/13HD)

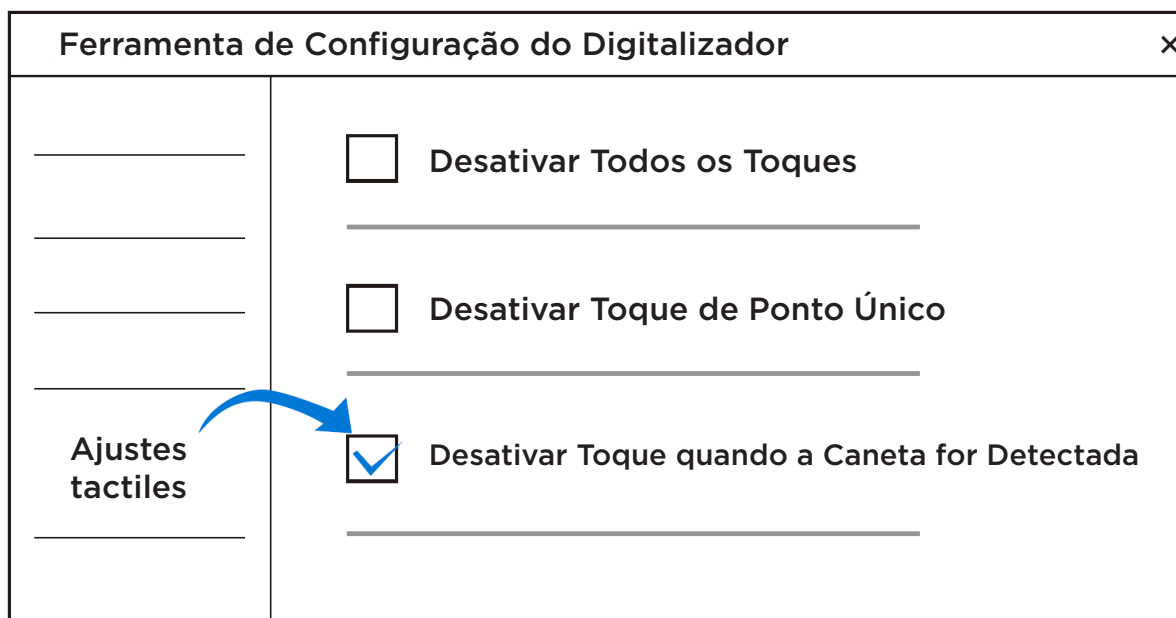

Nota: Selecionar “Desativar toque de ponto único” pode reduzir significativamente as operações falsas.

CONFIGURAR AS TECLAS

(Apenas para séries 12HDK e 13HD)

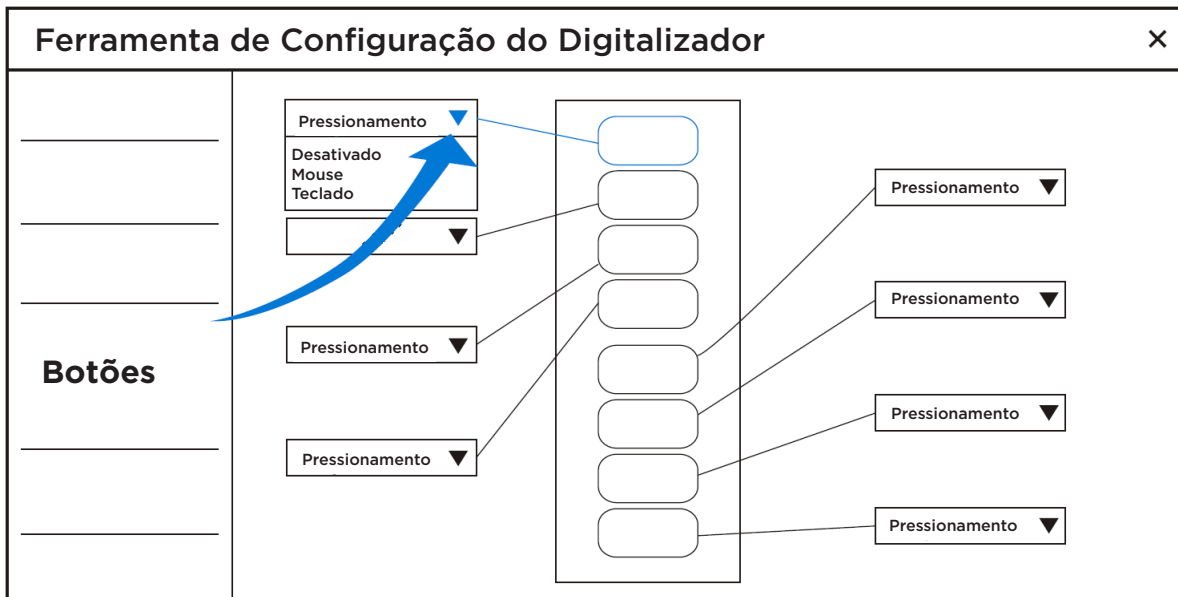

Nota: As teclas de atalho podem ser personalizadas

Definir como botões esquerdo e direito do mouse

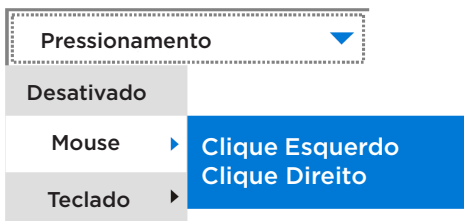

Definir como tecla do teclado

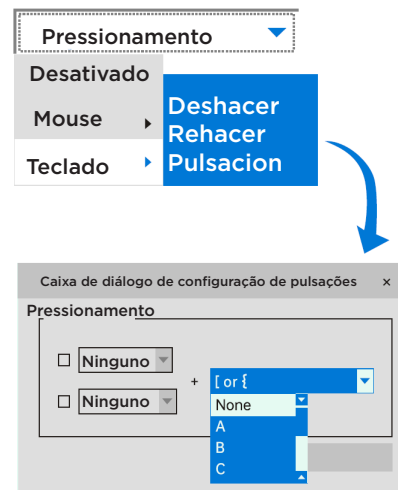

Definir como combinação de teclas

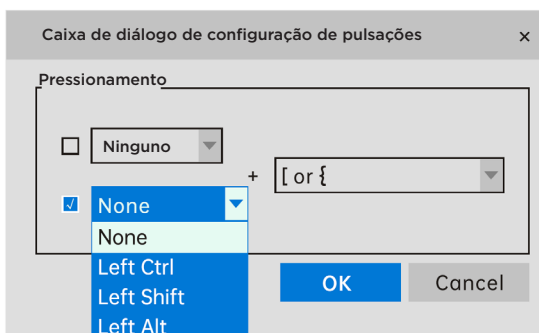

CONFIGURAR A CANETA SENSÍVEL À PRESSÃO

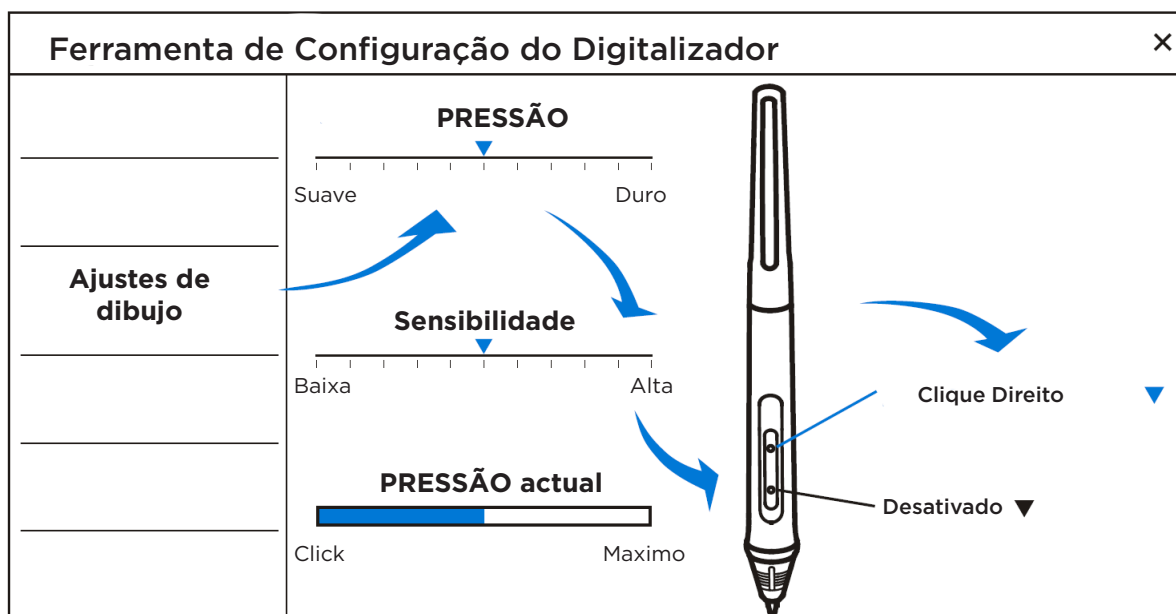

Ajuste de Pressão: Define a pressão mínima da caneta para o traço das linhas. Se você mover o controle deslizante da esquerda (Suave) para a direita (Duro), será necessária mais pressão para desenhar as linhas.

Ajuste de Sensibilidade: Modifica os intervalos de alteração da espessura das linhas durante o desenho. Se você mover o controle deslizante da esquerda (Baixa) para a direita (Alta), a linha ficará mais grossa sob o mesmo nível de pressão.

SUBSTITUIR A PONTA DA CANETA



User Manual

Digitizing tablet

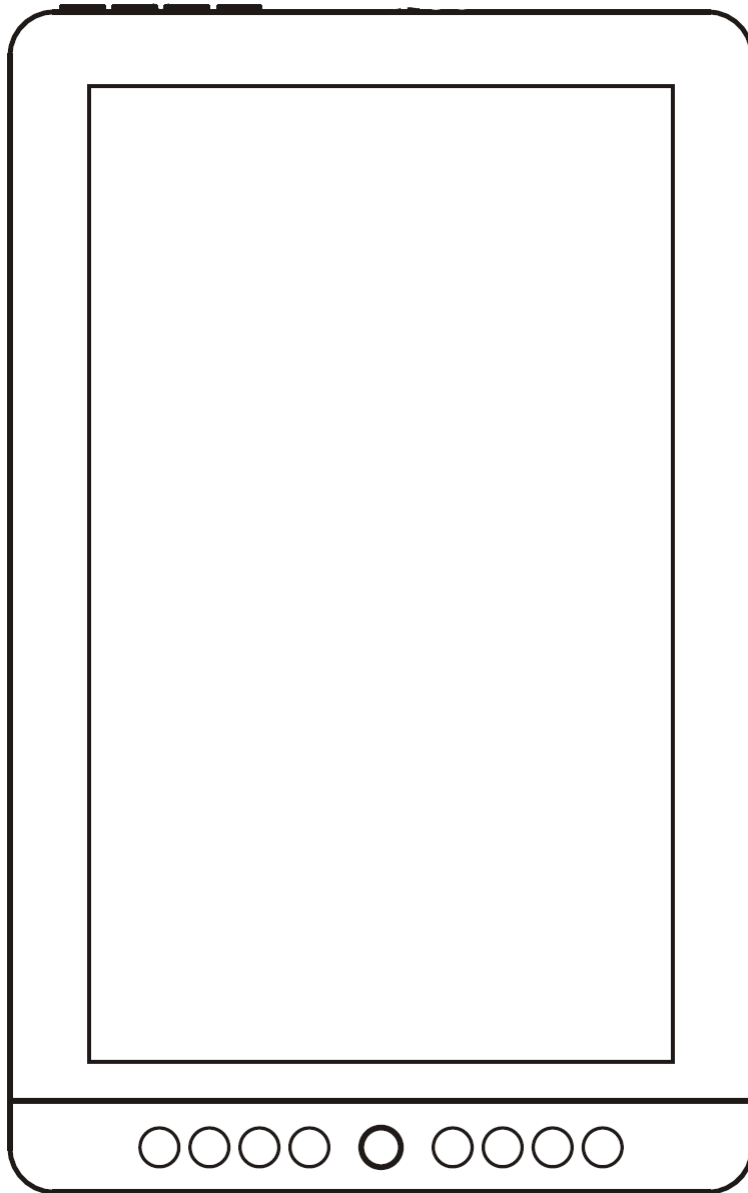

OVERVIEW

①~⑧ 8 custom Keys

⑨ Menu adjustment key

⑩ miniHDMI

⑪ Type-C

⑫ Foldable stand

⑬ Non-slip mat

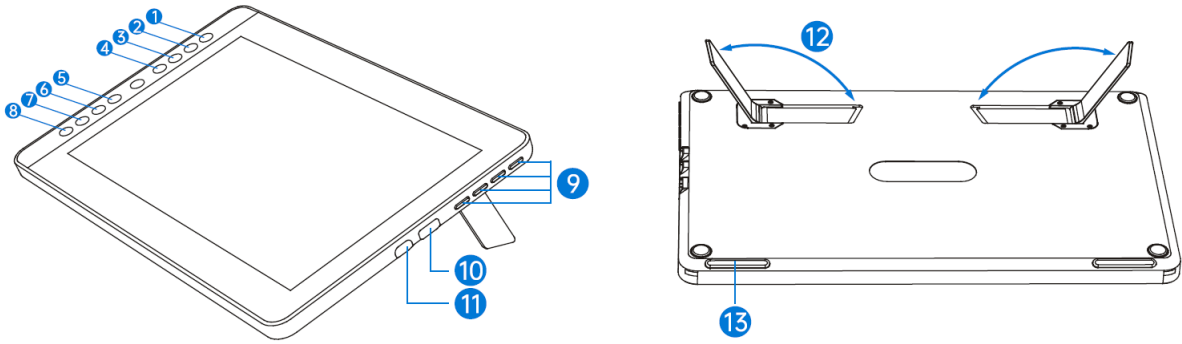

CONNECTION

Connect your tablet with the computer as shown:

① mini HDMI

② Type C

③ HDMI

④ USB

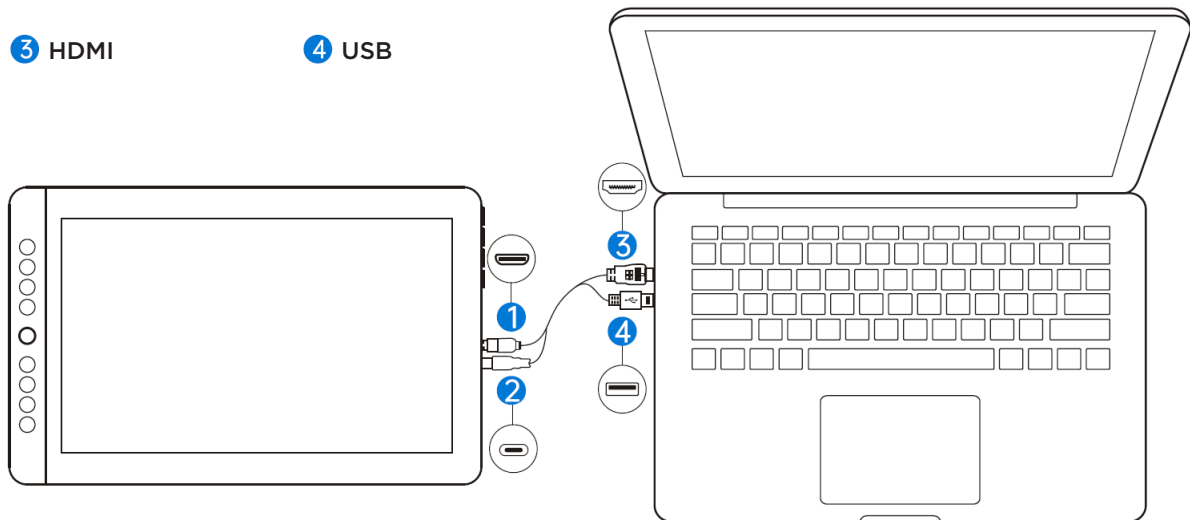

DRIVER INSTALLATION

1. Preparation before installation: Uninstall and remove other graphic tablet/monitor driver installed in your computer, quit all running programs, disable any anti-virus software and firewall temporarily, Installing the driver as administrator.

2. Download the driver from: <http://www.bostotablet.com/down.aspx>

3. After a successful installation:

- **Windows:** You can find the “Digitizer” Icon on the desktop or task bar bottom right corner of your computer.

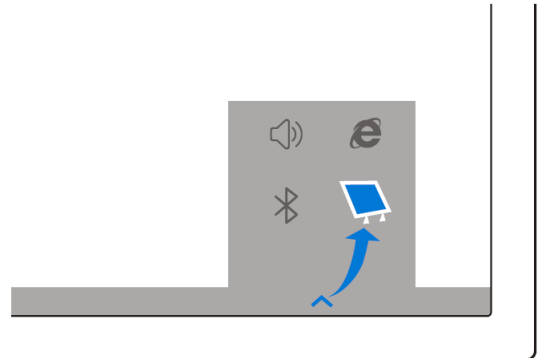
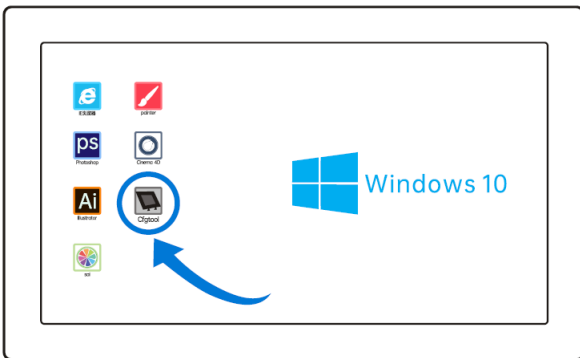

- **Mac:** You can find “Tablet” Icon in the “Launchpad”, after click it, you will see the small icon on the top right navigation bar (as shown in the picture below), click to open the driver settings panel.

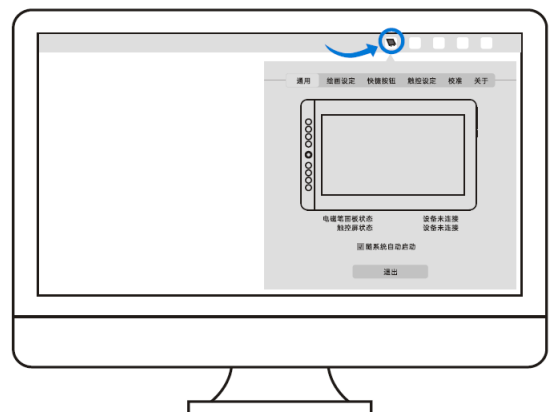
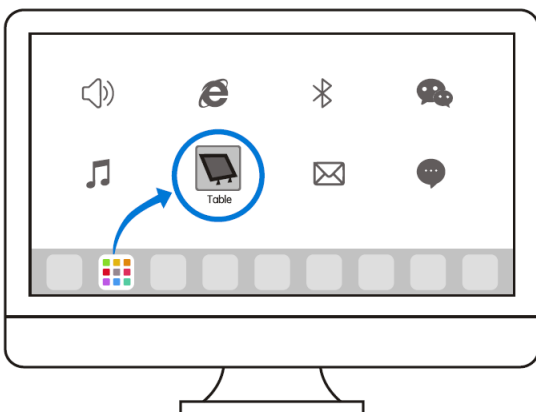

SCREEN CALIBRATION

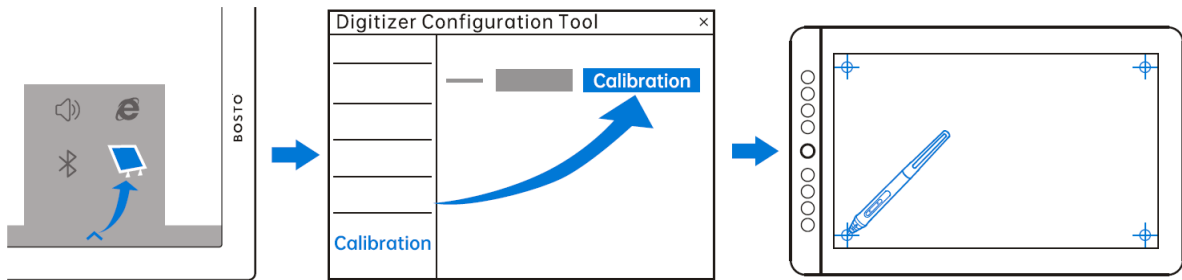

FINGER-TOUCH SETTINGS

(Only for 12HDT/12HDKT/13HD)

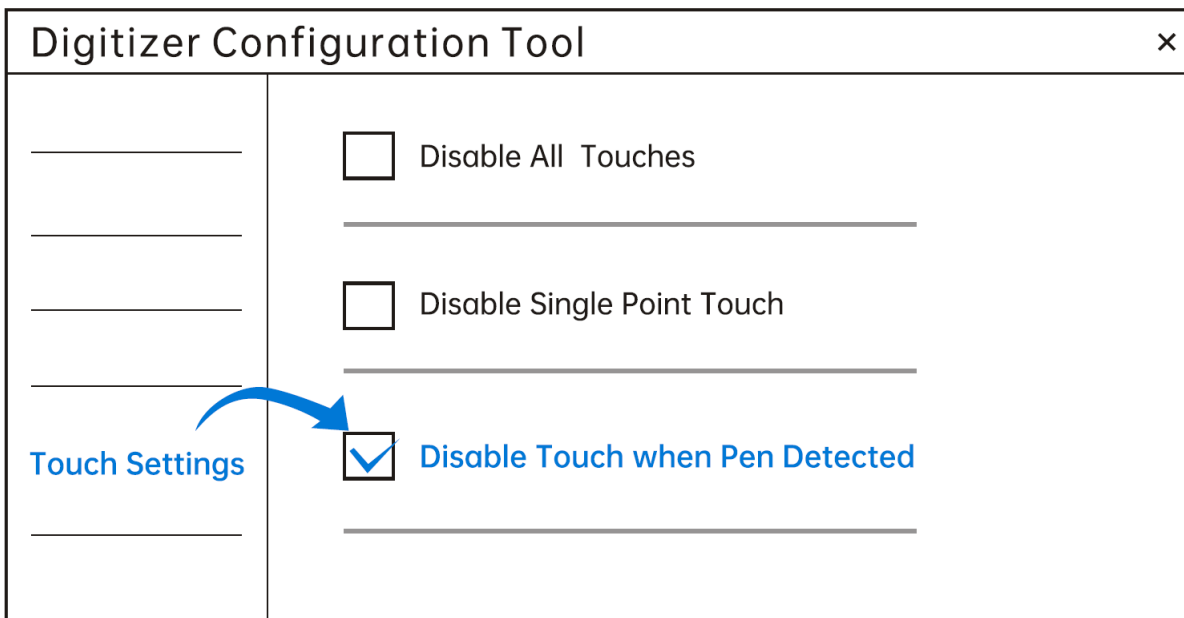

Note: Select the “Disable single point tough” can greatly reduce false operation.

SET THE KEYS

(Only for 12HDK e 13HD)

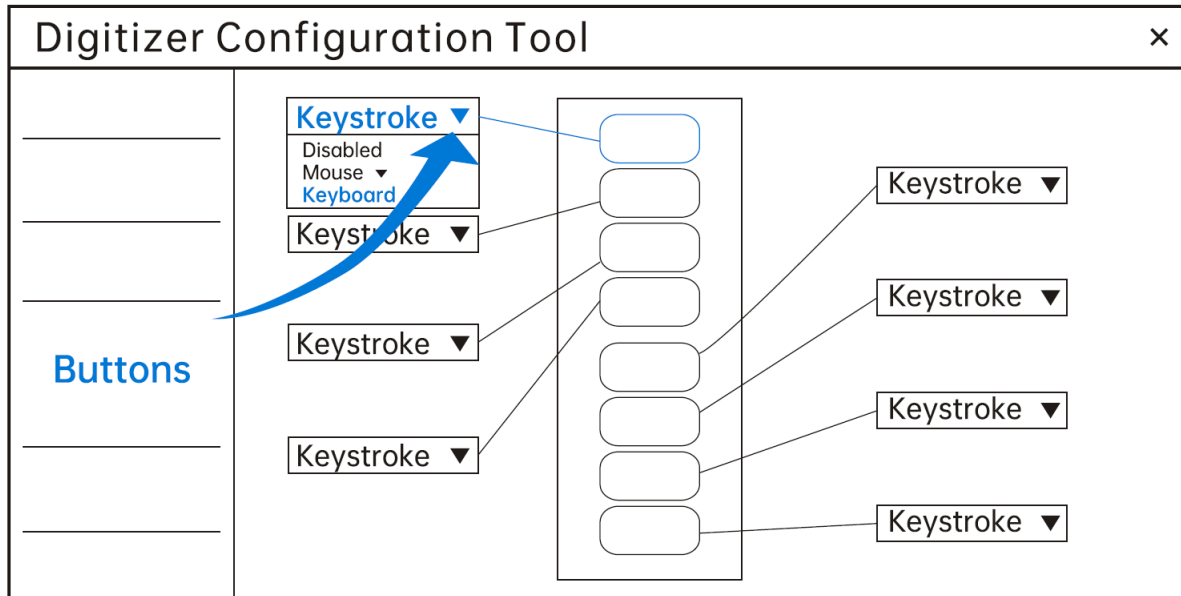

Note: Shortcut keys can be customized

Set to left and right mouse buttons

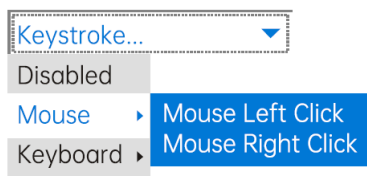

Set as keyboard key

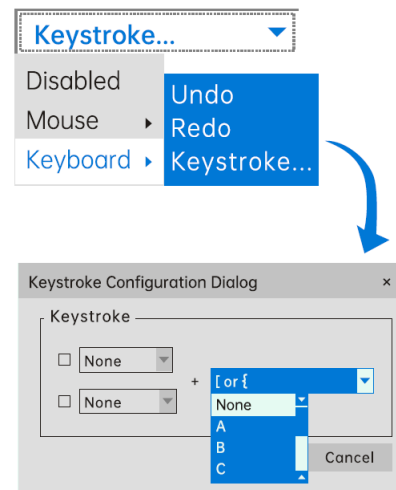

Set as key combination

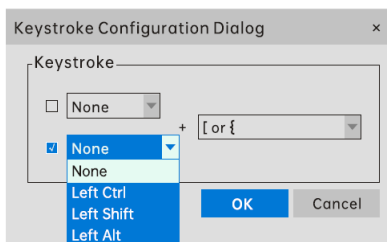

SET UP THE PRESSURE SENSITIVE PEN

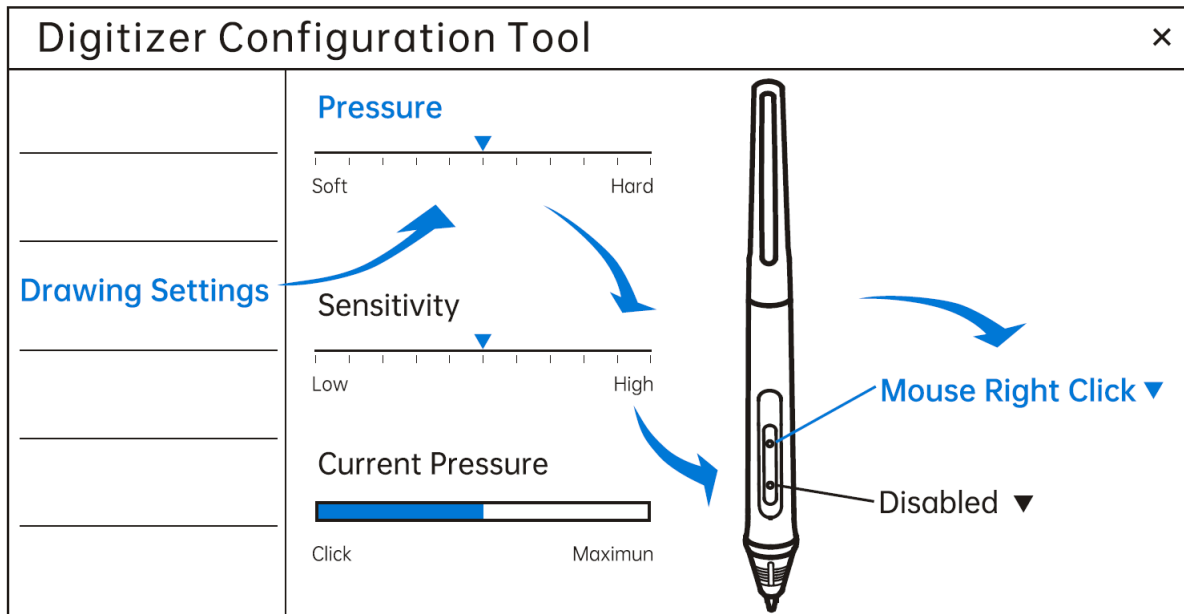

Pressure adjustment: Drawing the Minimum pen pressure of lines Move the slider to the right, more pressure required for drawing the lines.

Sensitivity adjustment: When drawing, the change ranges of the thickness for the corresponding lines, Move the slider to the right, the line is thicker for the same pressure.

REPLACE PEN NIB



¿Necesitás ayuda?

Ingresa a nuestro soporte técnico escaneando el QR o escribinos por nuestros canales oficiales.



11 6260 1114 (sólo texto)



serviciotecnico@bidcom.com.ar



www.bidcomservice.com.ar

Bidcom
SERVICE

